



# 75D LED STB GREEN 112.5° 24VDC

The Series 75 LED Navigation lights are applicable for all vessels  $\geq 20$  m in length. The LED Navigation lights fulfil all requirements of International Regulations for Preventing Collisions at Sea 1972 (COLREG) that are published by the International Maritime Organization (IMO) and local rules. Series 75 is available in Single version (Series 75), Double version (Series 75D), Single Arctic version (Series 75 Arctic) and Double Arctic version (Series 75D Arctic). Arctic versions are intended for use in low temperature areas, and includes a heating foil, on the inside of the glass lens, for de-icing. The Series 75 is based on the latest innovative LED and driver technology. Compared with conventional navigational lights and first generation LED navigational lights, the Series 75 set new standards in terms of lifetime, efficiency and reliability. The main and the back-up systems are compactly integrated in one housing. Series 75 navigation lights are available in black housing color.



Item Number	3678103000
GTIN	4036538641732
Stock status	A

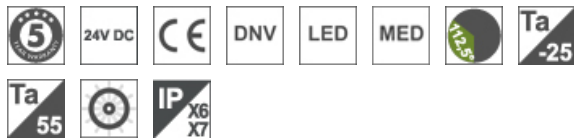

## Technical specifications

### Certificates

Certification	DNV
Marine Approved	True

### Technical Data

Minimum ambient temperature (°C)	-25
Maximum ambient temperature (°C)	55
IP classification	X6/X7
Lantern type	Double

### Light Technical Data

Light source	LED Green
Number of lamps	2
Power consumption light source (W)	5
Light source 2	LED Green
Power consumption light source 2 (W)	5
Light source included	True

### Lifetime

L70 Median useful life LED Ta45 (hr)	100 000
--------------------------------------	---------

### Electrical Data

Mains current	0.2
Mains current reserve 1	X
Main Feed DC (V) Min	21.6
Main Feed DC (V) Max	31.2
Sec Feed DC (V) Min	21.6
Sec Feed DC (V) Max	31.2
Total consumption (W)	5

### Optic

Output angle (°)	112.5
Visibility (nm)	3
Material of diffuser	Borosilicate glass
Diffuser material design	Clear

### Housing

Main body material	Polycarbonate
Surface treatment	Reinforced
Body colour	BL - Black
Main body colour name	Black

**Dimensions**

Length (mm)	248
Width (mm)	176
Height (mm)	222
Net weight (kg)	2.500008

**Logistic Data**

Item gross weight (kg)	2.7174
------------------------	--------

**Cable Inlet**

Cable gland	M25-Polyamide
Number of cable glands	2
Max cable diameter (mm)	17
Min cable diameter (mm)	10

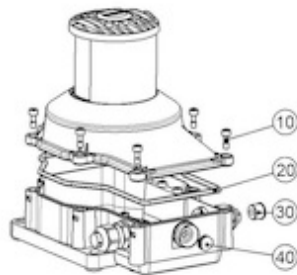
**Illustrations**

Spare Parts	
Pos.	Spare part no.
10	Screws stainless steel;6 pcs. E-2366502100
20	Gasket for housing,silicone;1 pc. E-2367501100
30	Reduction insert for connection cable;2 pcs. E-9060085000
40	Pressure equalisation with bush M20, polyamide;1 pc. E-9060036300

